

RIO GRANDE COUNTY

DRAWN BY A.O.D. DATE 1972-3
 CHECKED BY C.J.M. DATE 1972-3
 REVISED

Date	By	Remarks
9-25-77	JL	1-10-08 DA
9-23-77	EB	1-10-08 DA
8-2-78	CA	1-3-84 ES
3-31-80	EB	01-07-10 ES
1-22-81	EB	01-04-11 ES
12-31-81	BD	1-15-31 MS
1-31-80		
1-15-87	EB	
2-28-89	DM	
1-13-91	DM	
2-12-96	DM	
01-22-99	DA	
2-29-20	DA	

R 3 E				
09				
21	19	17	15	13
23	25	27	29	31
49	47	45	43	41
51	53	55	57	59
R 5 E				

COUNTY INDEX

6	5	4	3	2	1
7	8	9	10	11	12
18	17	16	15	14	13
19	20	21	22	23	24
30	29	28	27	26	25
31	32	33	34	35	36

TOWNSHIP INDEX

A and E SUBD.
 LOTS 1 thru 4
 Fr. LOT 9 SEC 30
 55-300-05

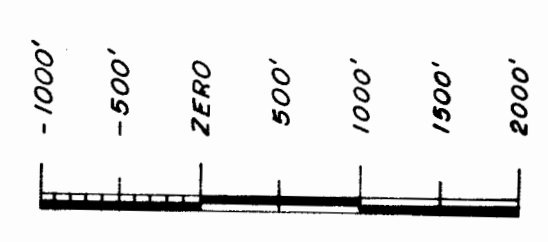
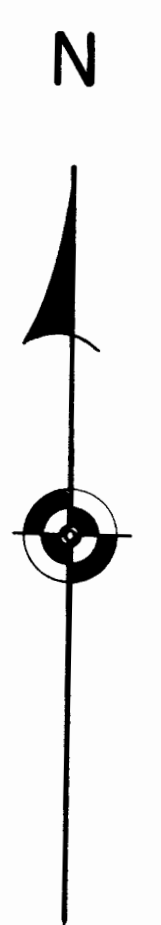

SCALE: 1" = 1200'

NOTE: All mines in Sections 17-18 & 20 should be relocated approximately 1500 feet East of present location

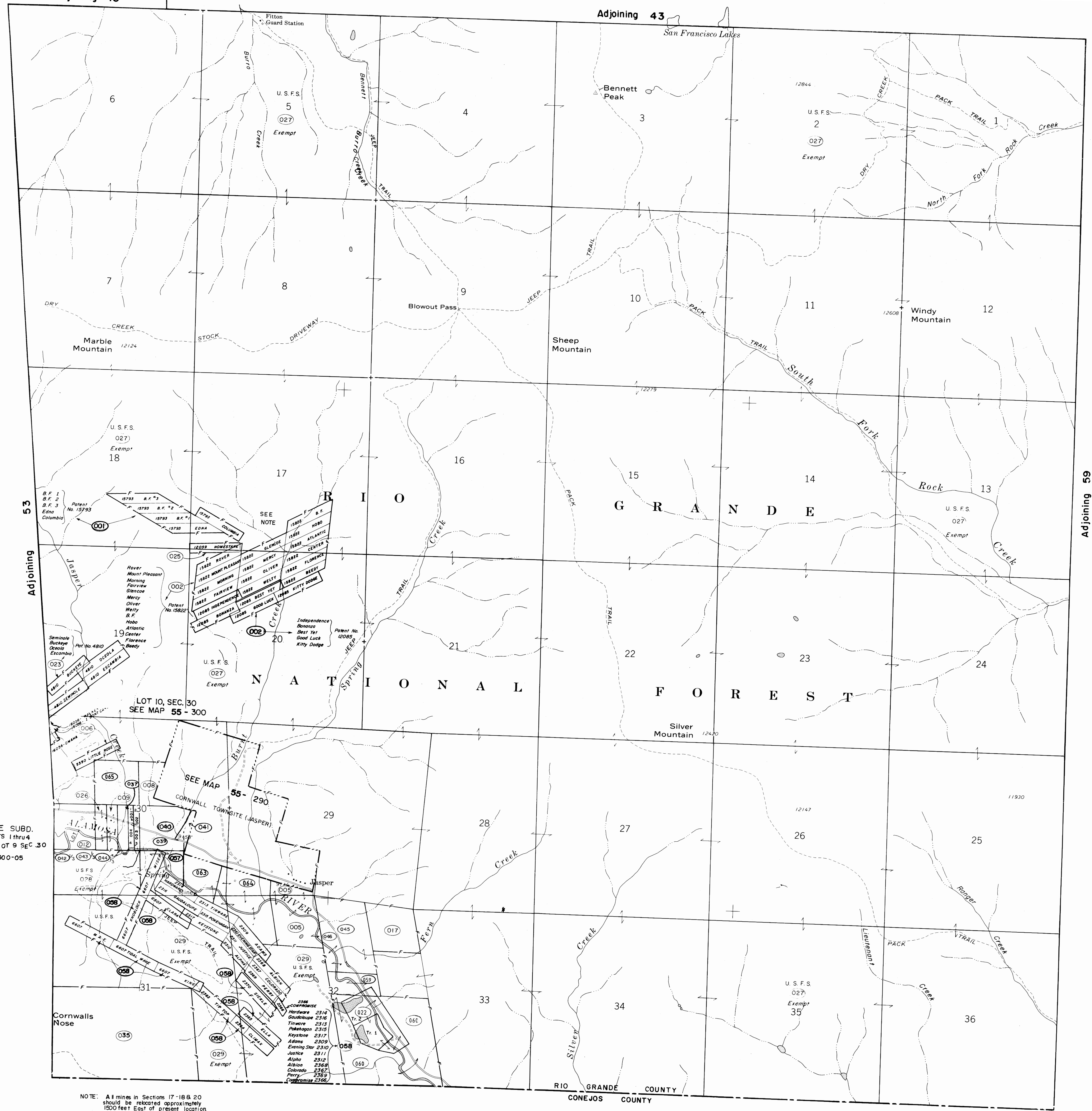

DAVIS ENGINEERING SERVICE, INC.
 P. O. BOX 67 - 576 SPRUCE ST.
 DEL. NORSE, COLORADO 81132

THIS MAP FOR ASSESSMENT PURPOSES ONLY NOT INTENDED TO BE USED FOR LEGAL PURPOSES